



WiseWay SNMP Communication Card

www.kehua.com

Stock Code
002335.SZ

Kehua Data Co., Ltd.

Introduction

The WiseWay SNMP is a monitoring product with network functions. It can monitor and manage a single UPS/HVDC device in real time. The user can remotely view the working parameters of the device and other dynamic parameters (battery pack, surrounding temperature, Humidity, water leakage, smoke, etc.) through a web browser.

It supports local storage of historical data and alarm events, and can notify users of alarm events in time via SMS, email, etc., Multiple encrypted access methods which is highly security and reliability can satisfy users for multiple UPS/HVDC and supporting peripherals. And it also supports centralized networked monitoring and management requirements.

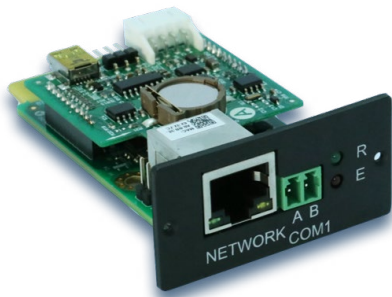

Internal SNMP card



External SNMP card

Structure

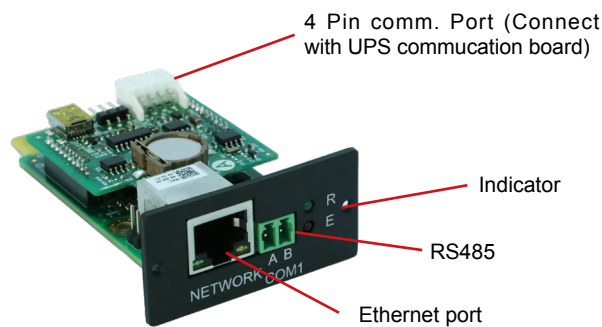

Internal SNMP card structure

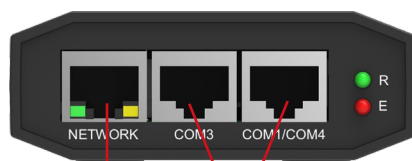

Ethernet Port (RJ45)

RS485/232 (RJ45)

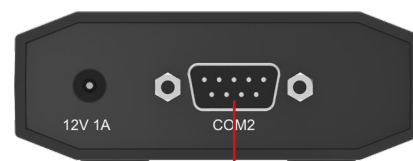

RS232 (DB9)

External SNMP card structure

Features

- Support all KEHUA UPS and HVDC product.
- Based on Linux system, support B/S access architecture, support windows, Linux, MAC, VMware, FreeBSD different operating system, convenient and fast.
- Large capacity of data storage, can support more than more than 10000 records.
- Support HTTP/HTTPS/SNMP access control, high security and confidentiality to prevent illegal access.
- Multiple alarm modes, support different settings, alarm Event Settings, alarm mode setting, user alarm setting, alarm linkage setting (can define alarm events that trigger UPS control operations), ensure system security and improve the system reliability.
- Support visual UPS/HVDC energy flow diagram, alarm display, control function; support statistical performance data, historical alarm, operation log viewing, retrieval, export and other functions.
- Support SNMP V1/V2/V3 protocol, protocol libraries can be downloaded through the web.
- Support IE, Firefox, Google and other browsers.
- Support check, retrieve, and export performance statistics, historical alarms, and operation logs.
- With fault recording function, it can quickly locate and analyze the original communication data.
- Combine with the WiseInsight, WiseFind and WiseClose software, it's convenient for operation. WiseInsight for the centralized monitoring, WiseFind for the research, Wiseclose for the shutdown function.
- External SNMP has multiple RS232/RS485 interfaces, supports optional kits like monitor of battery packs, temperature and humidity, ordinary air-conditioning, smoke detection and water leakage. It can be connected to an external 4G module for SMS notification.
- Integrated monitoring: All the devices can be connected into one SNMP card and combine with the WiseInsight software, all the devices can be centralized monitored, convenient to check the device status, save the maintenance time and cost.

Monitoring diagram

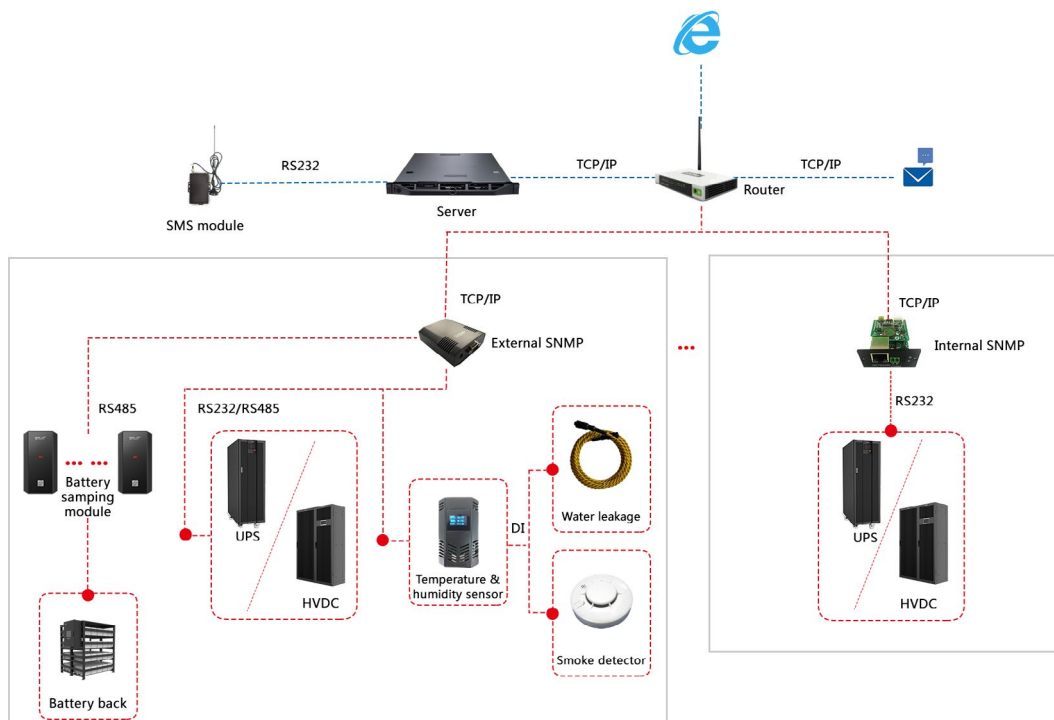

Specifications

MODEL	External SNMP Card	Internal SNMP Card
RAM	512MB	
Flash	4GB	
Mains input	DC9-15V, 1A, 2.5W	DC9-15V, 1A, 2.5W compatible with 5V power supply
Output power	RJ45 port, DC12V, 0.5A	No output power supply
Interface	<ul style="list-style-type: none">• 1 x DB9 port RS232; 2 x RJ45 port RS485 (DC12V, 0.5A, With reset pin)• 1 x RJ45 port RS232 (Multiplexing interface with RS485)• 1 x 10/100M adaptive network port	<ul style="list-style-type: none">• 1 x golden finger port RS232• 1 x 4Pin common. port (Reuse with the golden finger)• 1 x 2Pin port RS485• 1 x 10/100M adaptive network port
External device	UPS/HVDC (RS485/RS232) Battery sampling module (RS485) Temperature and humidity sensor &I/O module (RS485) SMS cat (RS232)	UPS/HVDC (RS232) Temperature and humidity sensor (RS485) SMS cat (RS232)
Indicator light	Red: fault light, Green: running light	
Storage temperature	-25°C~70°C	
Working temperature	- 5°C~50°C	
Working humidity	5%~95%RH (no condensation)	
Protection	IP20	
Size (L*W*G)	85*77*30mm	92*53*26mm
Installation	Magnetic suction fixed	Slot Fixed in the Slot or L-shaped plate
Certification	CE/FCC	

- Specification is subject to change without prior notice.

Kehua Data Co., Ltd.

Add: No. 457, Malong Road, Torch High-Tech Industrial Zone, Xiamen Fujian China

Tel: +86-592-5160516 Fax: +86-592-5162166 www.kehua.com

Version No.: 20221109



@2022 Kehua Data Co., Ltd. All rights reserved.